

DELTA CEIR Line, Deltaceir'in lineer versiyonudur, demonte edilebilir modüllerden oluşur. Deltaceir Line, "Δ" biçiminde üretilen profillerle oluşturulan bir petek tavan sistemidir. Bu sistem, asma tavan boşluğuna sık ve kolay erişim gereken alanlar için idealdir. Sistem, ince ve dekoratif, birbirine paralel şekilde monte edilmiş "Δ" biçimli lineer profillerin üzerinde destek köprüsü görevi gören bir profille bir arada tutulmasıyla oluşturulur.

ÖZELLİKLER

Deltaceir Line, 1200x600mm'lik modüllerden oluşur, "Δ" biçimli profiller belirli aralıklarla birbirine paralel olarak monte edilir (bu aralık 15 mm'den başlar). Profiller 4 mm taban eni, yükseklik 20 veya 30mm

ASKILI DEMONTAJ

Her bir modül tek kenarından aşağıya sarkıtılır ancak tamamen demonte edilmez, klipsler vasıtasıyla aşağı doğru sallandırılarak durur. Modüller 60cm'lik kısa kenardan demonte edilir ve boyuna doğru asılı bırakılır. İstek üzerine uzun kenardan demonte edilecek şekilde de üretim yapılabilir.

TEDARİK ŞEKLİ

DeltaceirLine nakliyyeyi kolaylaştırmak amacıyla çoğunlukla petek haline getirilmeden demonte olarak tedarik edilir. Ancak istek üzerine montajlı/petek haline getirilmiş olarak da sunulabilmektedir.

YANGIN DAYANIMI

Alüminyum asma tavan sistemleri uluslararası normlara göre yanmaz sınıftadır

MONTAJ

Delta Taşıyıcı Sistem ile DeltaLine petek tavan modüllerinin montajı kolay ve hızlıdır. Bu gizli taşıyıcı sistem, tavanda kesintisiz görünüm sunar. Tüm modüller birbirinden bağımsız olarak aşağı yönlü demonte edilebilir, bu da asma tavan boşluğunda gizlenen servis tesisatlarına kolay ve hızlı erişim sağlar.

ŞARTNAME:

Ürün:	Deltaceir Line
Tedarik şekli:	Hazır petek haline getirilmiş veya demonte
Malzeme:	0,40mm kalınlıkta alüminyum
Profil kesit :	"Δ" base 4 (h30) veya (h20) mm
Hücre aralığı:	.. mm
Panel ebadı:	1200x600mm (standard)
Yüzey bitiş:	..
Taşıyıcı sistem:	gizli taşıyıcı Delta taşıyıcı sistem



Deltaceir Line



DELTA CEIR Line is the linear solution of Deltaceir aluminium ceiling system, made up of modular panels which are fully downward demountable. With thin and very decorative "Δ" lines, this product features parallel profiles held by upper support bridges which placed over the panel will disappear when looking across the ceiling. The perfect solution for every project requiring exclusive design. The closed shape of the blades drastically reduces the buildup of dust, and so the settling in the space of harmful products to one's health.

FEATURES

DELTA CEIR Line features 1200x600 mm modular panels, made of closed "Δ" profiles spaced at any interval (pitch) from 15 mm. Profiles h30, 4 mm wide. Profiles h20, 4 mm wide.

The modular panels, 1200x600 mm, are suspended from the concealed Delta suspension system. Upon request, special modules are available: width up to 1200 mm and length up to 1800 mm.

DELTA CEIR Line blades are made by BENDING SYSTEM, which gives: the accuracy of profiles, more square edges and blades perfectly straight.

A wide range of finishes either from pre-painted or post-painted aluminium is available, according to the RAL, NCS, PANTONE and SIKKENS colours.

HINGE-DOWN PERFECT AND EASY

Each panel is fully downward demountable and can remain hinged-down in the springs without being totally removed.

The panels swing down from the short side (600 mm) and remain suspended at full length. Upon request, hinge-down from the long side (1200 mm) is possible too.

SUPPLY FORM

DELTA CEIR Line is usually supplied unassembled. It allows for easier packages and more economic transports. Upon request, the panels can also be supplied assembled.

FIRE REACTION

CEIR open cell ceilings are classified incombustible in compliance with international standards.

INSTALLATION

The concealed Delta suspension system allows for easy and fast placement or removal of DELTA CEIR Line.

The suspension system gives a trackless appearance and allows for demounting of the panels from below.

The minimum free space required for comfortable demounting is 80 mm only.

SPECIFICATION

Product:	DELTA CEIR Line
Supply form:	unassembled / assembled panels
Material:	0,40 mm. th. aluminium
Section blade:	"Δ", base 4 h30 or h20 mm.
Pitch:	at ... mm.
Panel size:	1200x600 mm. (standard)
Finish:	...
Suspension:	Delta system
Quantity:	... sq.m.

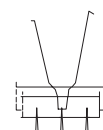
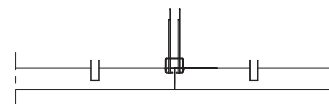
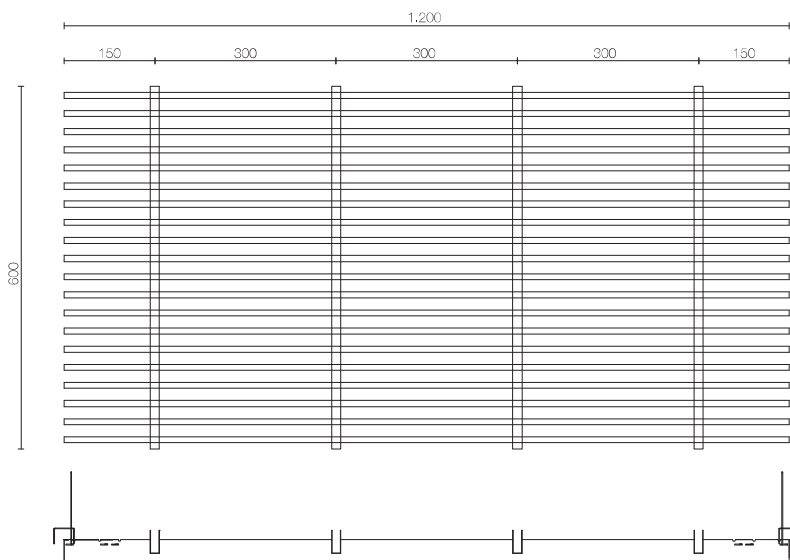
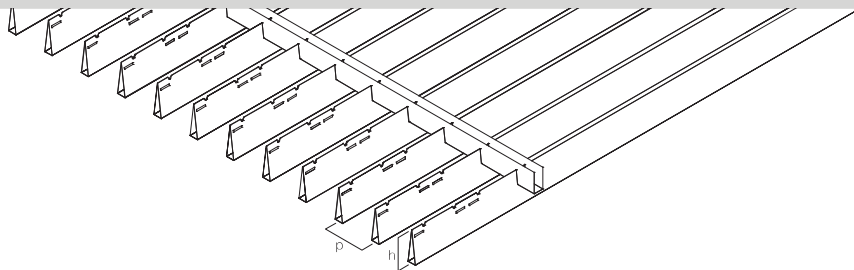
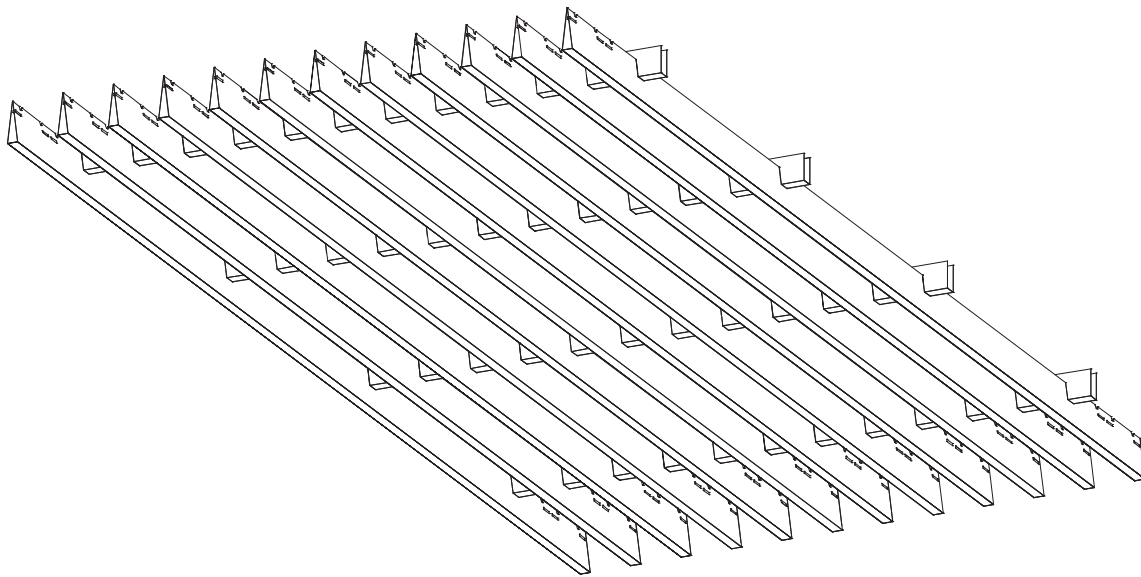

Deltaceir Line

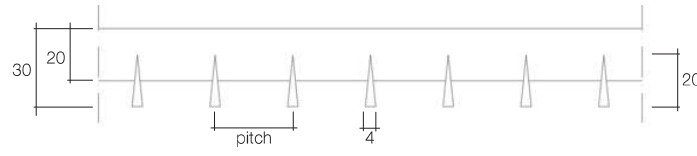

p	h
15	20
20	20
25	20
30	20

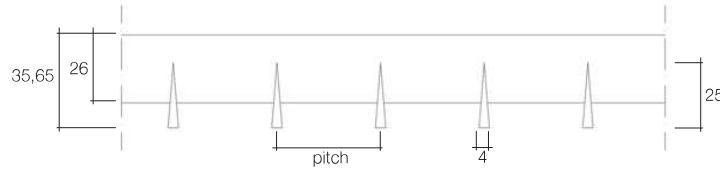

p	h
15	25
20	25
25	25
30	25

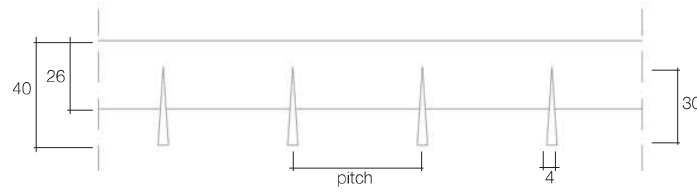

p	h
20	30
25	30
30	30
40	30
50	30

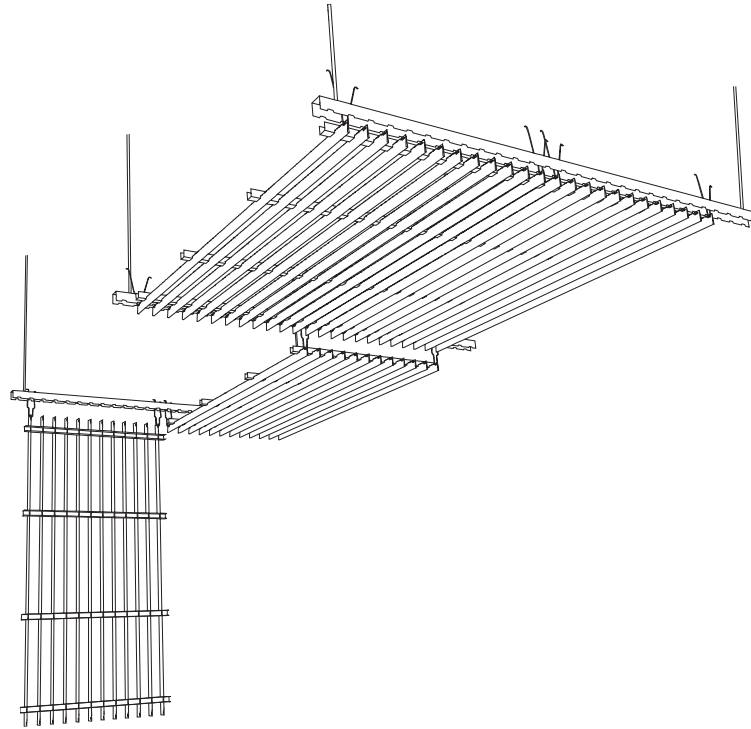
Montaj
InstallationMontaj aksesuarları
Accessories for installation

Deltaceir Line - Delta standard sistem / Delta standard system

m ² sarfiyat tablosu components per sq.m.	birim unit	panel / panel 1200 x 600
D001 taşıyıcı kanal / suspension channel	lm	0,80
D002 taşıyıcı ekleme / coupler	pc	0,28
D003 taşıyıcı birleşim klipsi / spring	pc	5,56
D004 askı tiji / rod	pc	0,80
D010 panel destek profili / panel support bridge	pc	5,56