



WHAT LOOKS  
BETTER THAN  
A MONOLITHIC  
CEILING?

---

# ONE MADE FROM NEW ROCKFON MONO® ACOUSTIC

---

Smoother and whiter than ever before, the new generation of ROCKFON Mono® Acoustic features an improved, seamless finish, fantastic acoustics and total design flexibility.

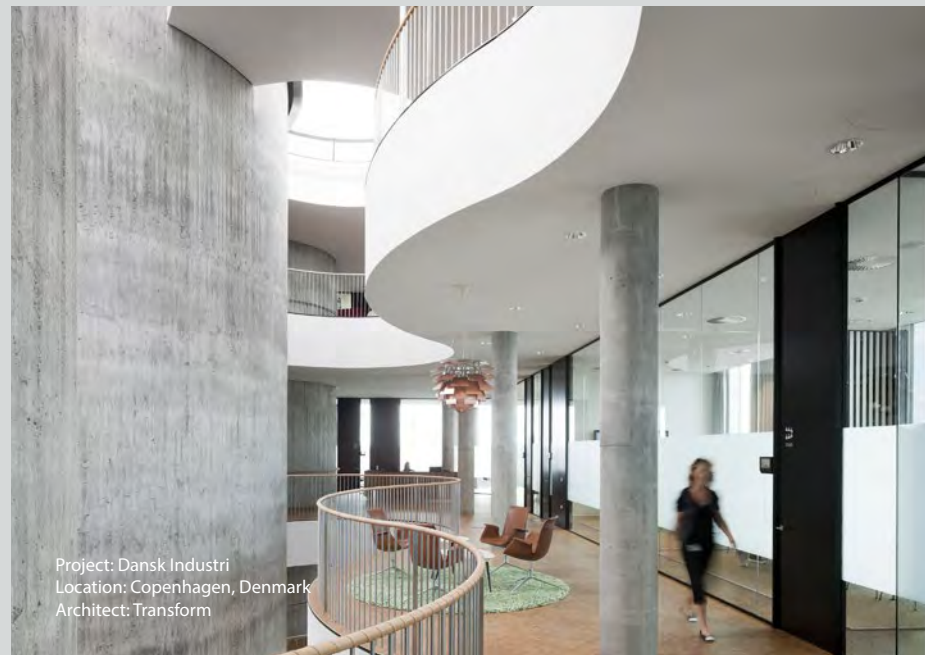

Project: Dansk Industri  
Location: Copenhagen, Denmark  
Architect: Transform

Project: Rochdale Metropolitan Borough Council  
Location: Rochdale, UK  
Architect: FaulknerBrowns  
Installer: PANARC Interior Solutions



---

# SMOOTH FINISH

---

The smooth finish of ROCKFON Mono Acoustic creates a seamless monolithic surface. Whether sloped, flat or curved, in white or colour, Mono Acoustic offers complete design freedom and allows the ceiling to play an active role in the room's architectural expression.



Project: Roland Garros Players' Restaurant  
Location: Paris, France  
Architect: Didier Girardet (ACD Girardet et Associés)  
Installer: Aquilon



Project: Rochdale Metropolitan Borough Council  
Location: Rochdale, UK  
Architect: FaulknerBrowns  
Installer: PANARC Interior Solutions

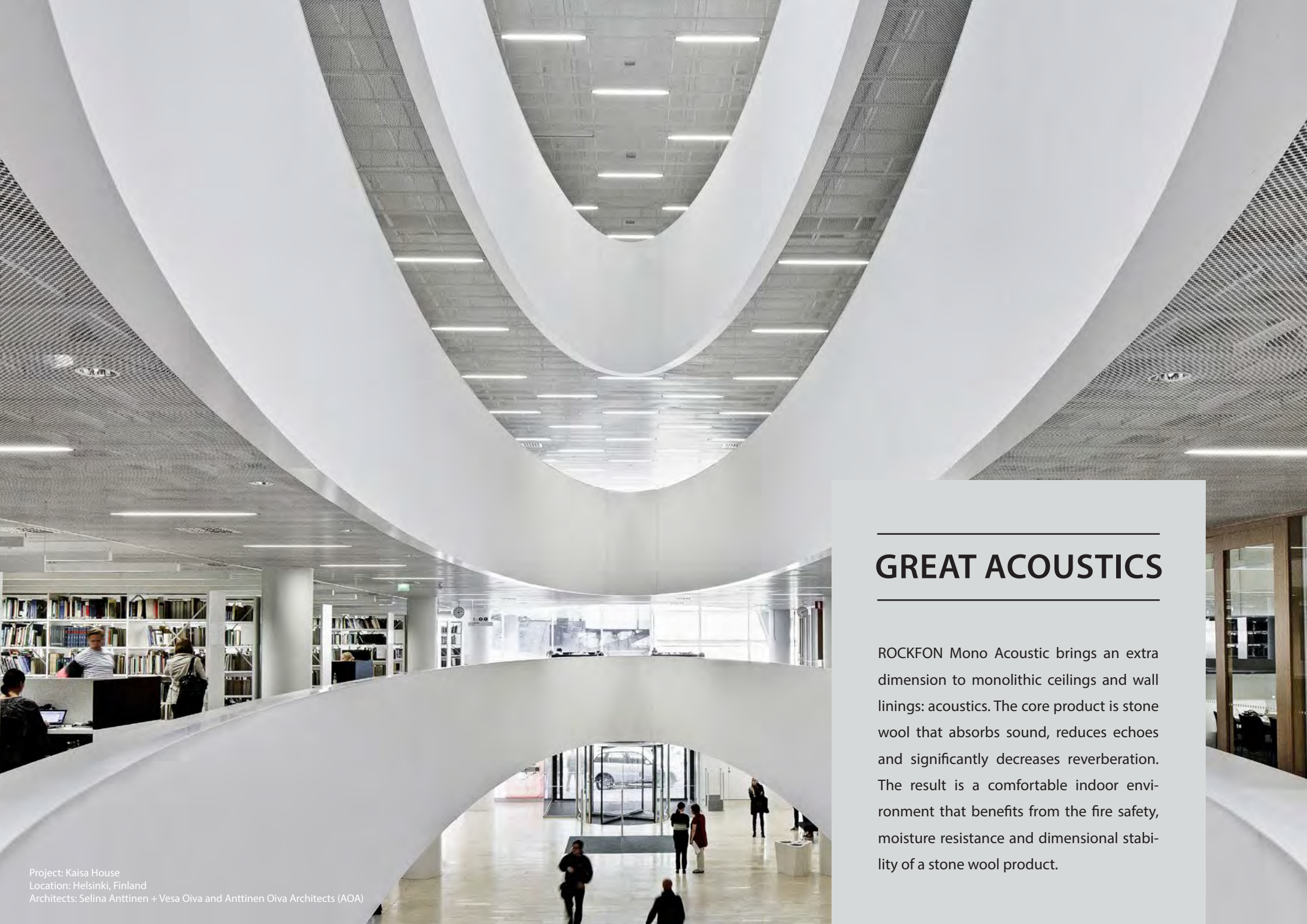

---

## GREAT ACOUSTICS

---

ROCKFON Mono Acoustic brings an extra dimension to monolithic ceilings and wall linings: acoustics. The core product is stone wool that absorbs sound, reduces echoes and significantly decreases reverberation. The result is a comfortable indoor environment that benefits from the fire safety, moisture resistance and dimensional stability of a stone wool product.

---

# FOR NEW BUILD OR RENOVATION

---

Available in white or bespoke colours, ROCKFON Mono Acoustic adapts to any space, both new builds and renovations. Its timeless, monolithic look complements the character and original architecture of historic buildings and makes Mono Acoustic an ideal choice for renovation projects. Equally suitable for new builds, it can be installed in large atriums or smaller rooms as seamless spans, ceiling islands and on walls. Offering total flexibility, Mono Acoustic can be shaped into concave, convex or S-shaped curves while allowing the incorporation of light wells, lighting, air-conditioning and ventilation systems as well as inspection hatches.



Project: Mobalpa Showroom  
Location: Paris, France  
Architect: Patriarche & Co



Project: La Comédie-Française  
Location: Paris, France  
Architects: Stéphane Delaby and Agence Brossy & Associés



Project: Astrup Fearnley Museet  
Location: Oslo, Norway  
Architects: Renzo Piano Building Workshop and Narud Stokke Wiig Architects

---

## SMART INSTALLATION

---

Ideal for any space, ROCKFON Mono Acoustic can be installed on a Chicago Metallic® suspension system or directly mounted on existing ceilings and walls. ROCKFON provides technical support and training courses for installers to ensure a high-quality finish and performance. Installation may only be completed by authorised Mono Acoustic installers who have successfully completed the training programme. Please contact ROCKFON for a list of authorised installers.



Project: Vredespaleis  
Location: The Hague, the Netherlands  
Architects: Wilford Schupp Architecten and BD architectuur

Please refer to the Mono Acoustic solution library and installation guide at [www.rockfon.co.uk](http://www.rockfon.co.uk) for further information.

# WE BELIEVE

OUR ACOUSTIC STONE WOOL AND METAL SOLUTIONS FOR CEILINGS AND WALLS ARE A FAST AND SIMPLE WAY TO **CREATE** BEAUTIFUL, COMFORTABLE AND SAFE SPACES. EASY TO INSTALL AND DURABLE, THEY **PROTECT** PEOPLE FROM NOISE AND THE SPREAD OF FIRE. THEY ARE OUR WAY OF MAKING A CONSTRUCTIVE CONTRIBUTION TOWARDS A **SUSTAINABLE FUTURE.**

# CREATE

AND **IS WHAT DRIVES US.**  
IT MEANS PUTTING PEOPLE FIRST,  
SHARING SUCCESS AND MAINTAINING TRUST.

# PROTECT

IT'S OUR **ROCK-SOLID PROMISE** TO YOU. AT ROCKFON, **CREATE AND PROTECT** IS WHAT WE DO – AND IT'S **INSPIRED BY YOU.**

## ROCKFON

A trading division of ROCKWOOL Limited  
26-28 Hammersmith Grove, London, W6 7HA  
Tel: 020 8222 7457  
Fax: 020 8222 7458  
[www.rockfon.co.uk](http://www.rockfon.co.uk)